

**Ethelbert Road  
West Wimbledon, SW20 8QE**

**£1,200,000 Freehold**



**This stunning 1,845 sqft fully extended, FOUR BEDROOM, TWO BATHROOM Terrace House has been finished to an exceptional standard throughout. Located on a sought after residential road within catchment area for Ursuline High School and Wimbledon Chase Primary School's admission priority area. There are ample transport options with links from Raynes Park and Central Wimbledon Station's. Internally the house has a gorgeous 7.52m x 6.56m open plan kitchen/dining family room, separate front reception room, downstairs w.c, low maintenance landscaped rear garden and a fantastic principle bedroom with en-suite bathroom. Offered to the market with no onward chain.**

**ETHELBERT ROAD, SW20**

Approx. Gross Internal Floor Area

**1845 Sq. ft/171.40 Sq. m**

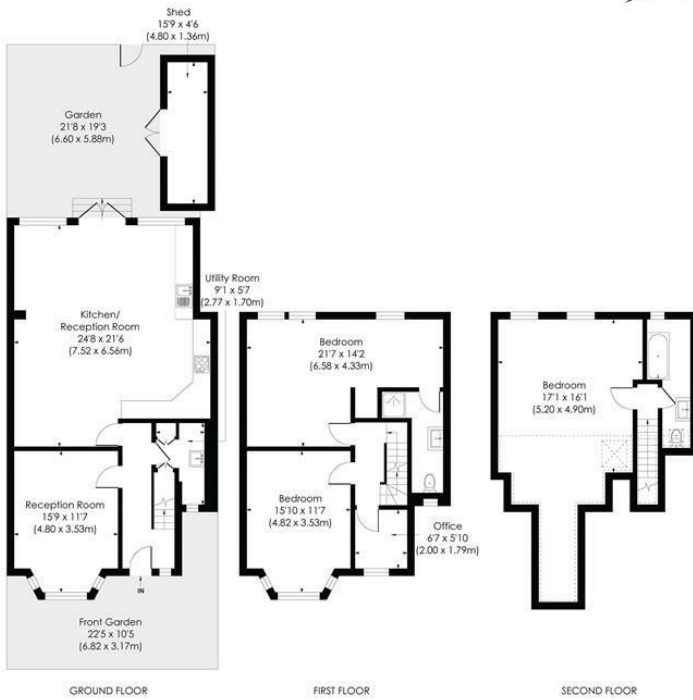

**pixangle**  
PROPERTY MARKETING

© Pixangle Property Marketing Ltd. info @pixangle.com Tel: 0208 870 2118  
This floor plan has been prepared for illustration purposes only, in accordance with the latest RICS code of measuring and is not to scale.  
All measurements and areas are approximate and whilst every effort has been made to ensure the accuracy of the plan contained here, no responsibility is taken for any error, omission or misstatement.

- Four Bedroom - Two Bathroom
- 1,845 sqft Fully Extended Mid Terrace House
- Stunning 7.52m x 6.56m open plan Kitchen/Dining/Family Room
- "Low Maintenance" South Facing Landscaped Garden
- Close to Ursuline and Wimbledon Chase Schools
- South After Residential Road - Chain Free
- Close to Raynes Park and Wimbledon Stations
- Exceptional Finish Throughout
- EPC Rating - D
- Council Tax - F

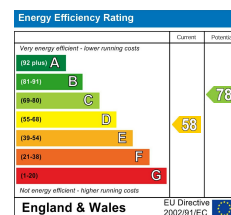

**For Free Mortgage Quote and Best Mortgage Rates, call Ellisons Mortgage Advisor on 0208 944 9595**



Although these particulars are believed to be correct, their accuracy is not guaranteed and they do not form part of any contract.

**Celebrating 30 years of successful Sales and Lettings in Merton**

